

### Kit Contents:

- iSWAB vial
- Sterile swab pack (with 2 swabs)
- Plastic "biohazard" bag with absorbent pad\*
- The outer box will be used to mail back the sample
- Bandage
- Lancet device
- Alcohol prep pad
- Extra barcode label (for lab use only)

\*Item may not be included in certain countries.  
Only iSWAB vial included in the rack format



**Read ALL steps before collecting samples!**

### Important:

- Do not touch swab tips or allow contact with any other object.
- You will be using **BOTH** included swabs



Place vial standing up on flat surface. Peel open bag containing swabs and remove a swab. Unscrew vial cap.

### A. Fingertip Sample

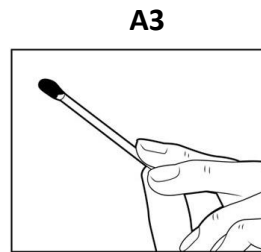
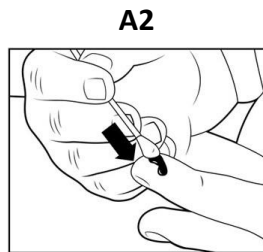
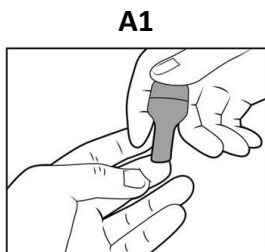

- A1.** Choose a central position on the tip of any finger or thumb of your non-dominant hand. Avoid old wounds or scars.
  - a) Clean the area with an alcohol pad and allow to dry.
  - b) Take the lancet and remove protective cap by twisting and pulling straight out.
  - c) Place the lancet against the chosen site and press the push button to puncture
- A2.** Allow a blood droplet to form; it may be necessary to gently squeeze the finger from the bottom up to the puncture site to produce a sufficient drop.
- A3.** Use both swabs to collect blood. Collect at least 3 drops per swab, making sure entire swab head is covered. Re-apply pressure as needed to form additional blood drops. When finished, clean puncture site with alcohol pad and bandage. After both swabs have been used, proceed to sample stabilization step.

## B. Heel Sample

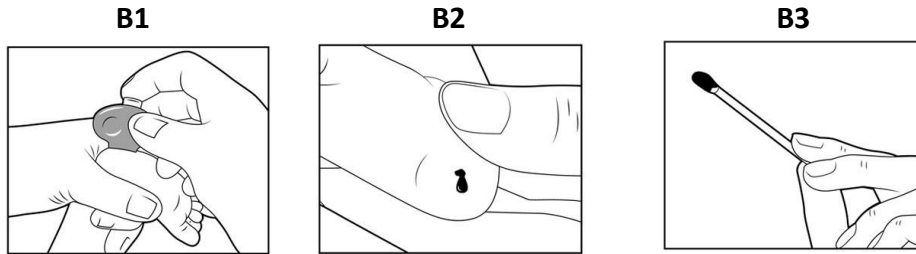

**B1.** Choose a central position on the baby's heel. Avoid old wounds or scars.

- Clean the area with an alcohol pad and allow to dry.
- Take the lancet and remove protective cap by twisting and pulling straight out.
- Place the lancet against the chosen site and press the push button to puncture

**B2.** Allow a blood droplet to form; it may be necessary to gently squeeze the area around the puncture site to produce a sufficient drop.

**B3.** Use both swabs to collect blood. Collect at least 3 drops per swab, making sure entire swab head is covered. Re-apply pressure as needed to form additional blood drops. When finished, clean puncture site with alcohol pad and bandage. After both swabs have been used, proceed to sample stabilization step.

## Sample Stabilization

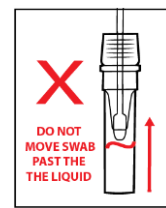
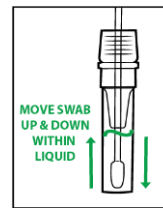

1. Pick up vial and hold steady in one hand. Slowly twist a swab into iSWAB vial with a corkscrew motion. There will be resistance, but push swab all the way to the bottom of tube.

2. Hold vial steady and move swab up and down rapidly in the tube 10-15 times without moving the swab out of the liquid.

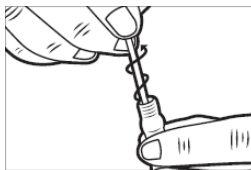

At this point remove and discard the swab. Hold vial firmly and remove swab by slowly twisting out with a corkscrew motion.

**DO NOT PLACE SWABS IN THE BIOHAZARD BAG.**

**REPEAT COLLECTION AND STABILIZATION STEPS WITH BOTH SWABS. Make sure you have used both swabs**

**For home collection:** Continue with steps 1-4 below

**For lab or onsite collection:** Proceed with sample processing or storage

- Replace cap tightly and place vial in Biohazard bag. The extra barcode label is for lab use only. Place Biohazard bag with vial and extra barcode label back in the box.
- Place a return address label on top of the box over the original label, and return postage on the upper right corner.
- Place the "Exempt Human Specimen" label on the bottom left, so it is not covering the postage or return address label.
- Peel the tape strip from under the top flap and re-seal the box.